

3" "CHEMFLY"™ clamped butterfly valve

Installation sheet

3" "CHEMFLY"™
clamped butterfly valve

INSTALLATION

The leakproof faces of the valve are machined with a rounded bottom spiral groove (stock finish).
The mounting flange must be machined in identical or similar fashion.

ASSEMBLY

- Make sure no dirt or grit has remained on the receiving flange and gasket.
- Minimum clam bolts torque is 3m.daN.m
- In order to avoid any damage caused to the valve seat when doing the equipment assembly, ensure the butterfly is in the closed position.
- Valves must be centrally adjusted before clamping.

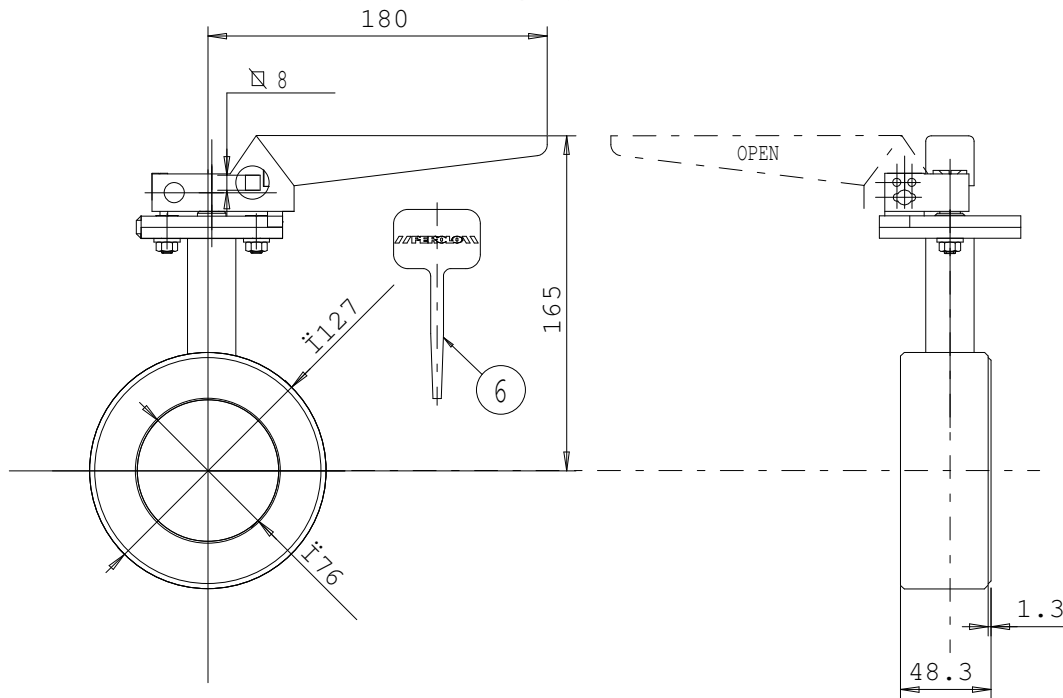

ACCESSORIES

Rep	Description	Part N°
1	3" BSP outlet flange	12.85.69.10.00
2	Bolting kit	12.85.84.91.00
3	Jacketed gasket	12.91.42.00.00
4	Jacketed gasket	12.91.39.00.00
5	Flange welding neck	11.11.33.00.00
6	Handle locking key	17.12.01.30.00
7	Spacer set	12.85.57.91.00