

### MAINTENANCE

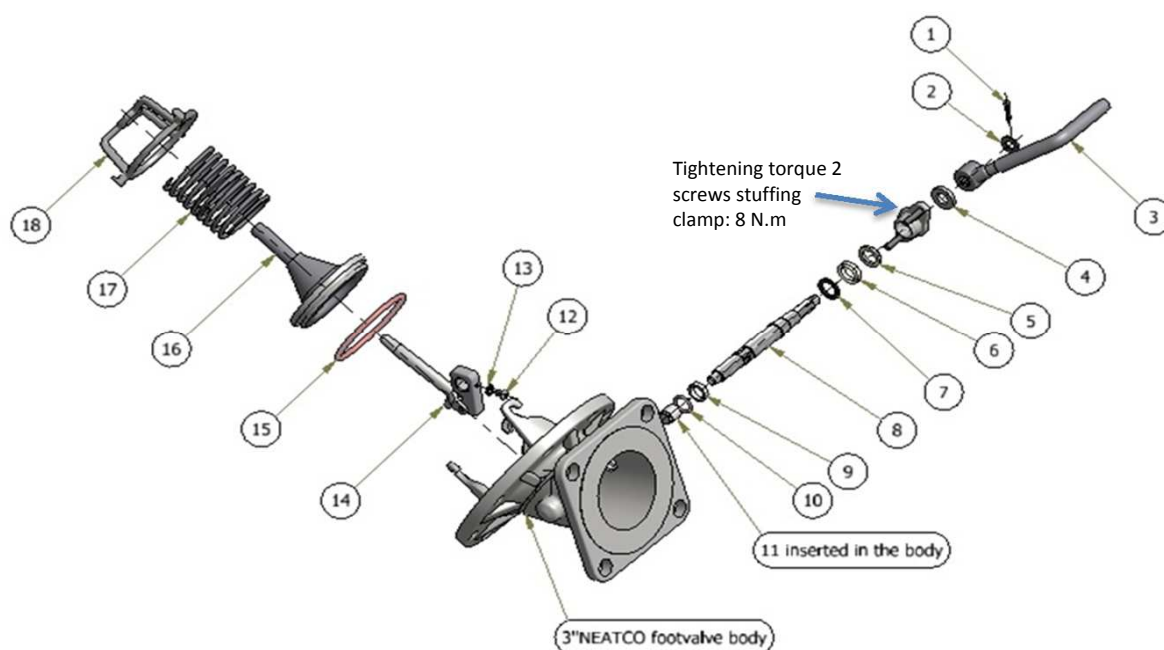

ITEM	QTY	DESIGNATION	PART N°
<b>Spindle kit:</b>			
8	1	Spindle, stainless steel	11 16 01 00 01
<b>Spindle seal kit: 11 16 01 93 00</b>			
1	1	Split pin, stainless steel	-
2	1	Washer, stainless steel	-
4	1	Spacer, stainless steel	-
6, 5	1	Packing gland, PTFE	12 85 30 30 00
7	1	Packing ring, PTFE	12 85 30 00 02
9	1	Spindle bush, PTFE	11 16 01 00 03
10	1	O'ring, FEP/silicone	70 10 15 00 12
11	1	End spindle bush, PTFE & 25% glass	17 16 23 10 01
<b>Pushrod kit: 11 16 01 92 00</b>			
12	1	M6-8 screw, stainless steel	-
13	1	M6 washer, stainless steel	-
14	1	Crank & pushrod, stainless steel	11 16 01 30 00
<b>Bayonet cap &amp; spring:</b>			
18	1	Bayonet cap	11 16 01 00 04
17	1	Spring, stainless steel	12 85 38 00 02
<b>Poppet kit: 1111149700mk2</b>			
16	1	Poppet, stainless steel	11 16 01 20 00
15	1	O'ring, FEP/silicone	70 10 15 00 53

Nb: Perolo recommends the spindle seals should be changed simultaneously to maintain the valve spindle perfectly tight.



**BOTTOM DISCHARGE**