

MAINTENANCE

VALVE INSTALLED ON THE TANK

1. Check the tank pressure is lower than the service pressure.
2. Go to the area where the valve is installed.
3. Check no leak exists between the poppet seal and the seat, this check can be done with leakage detection fluid. If a leak exists, follow next points to dismantle the relief valve for further maintenance.

REMOVE THE VALVE FROM THE TANK

This operation is done to change the valve for further check

1. Before any operation, check there is no pressure in the tank.
2. Unscrew the screws that hold the MEGA-SUPERVENTIX to the tank pad, remove the valve and the disc.
3. Plug the hole in the flange with a blind cap to protect the tank from dust.

Further valve disassembly should be done in a workshop.

RELIEF VALVE DISASSEMBLY

We recommend this operation every two years.

CAUTION: the springs load is between 100 daN en 700 daN, when cap is removed the springs can violently be ejected.

We recommend to safely disassemble the cap and slowly relief the spring set load.

1. Remove carefully the cap considering the above caution.
2. Remove springs set (2) and pressure plate (6)
3. Remove pressure seal (7)
4. Install a new seal
5. Reassemble the valve.

RELIEF VALVE ASSEMBLY

1. Fit the new O'ring (7) around the poppet.
2. Fit the poppet (8) into the pressure plate (6).
3. Apply threadlocker (as loctite) and screw the two nuts.
4. Compress the springs (2) and screw the top cap.



1

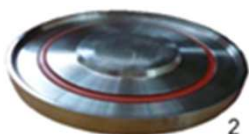

2



3



4



2 1/2" (ND65) SAFETY RELIEF VALVE

HIGH PRESSURE BSP MEGA SUPERVENTIX MH65F



ITEM	QTY	DESIGNATION	PART N°
Spring sets:			
2	1	Spring set pressure 9 Bar	11 10 49 00 02
2	1	Spring set pressure 11 Bar	11 10 49 00 03
2	1	Spring set pressure 14 Bar	11 10 49 00 08
O'ring:			
7	1	Pressure O'ring (FEP/Silicone)	11 10 01 99 05

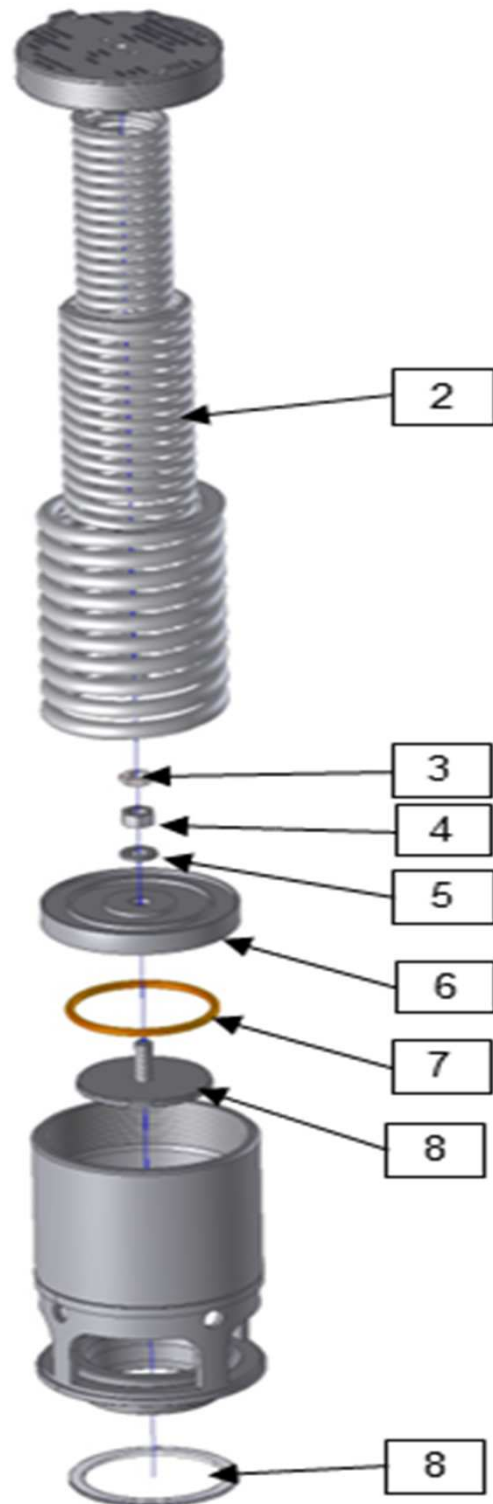

SAFETY RELIEF VALVE