

INSTALLATION

Weld the nozzle (9) on a 3" pipe (Ø89 x Ø80). Use MAG or TIG welding process with a fully interpenetrated welding process. Before welding the welding neck, please disassemble the valve from the welding neck. Reassemble once welding completed.

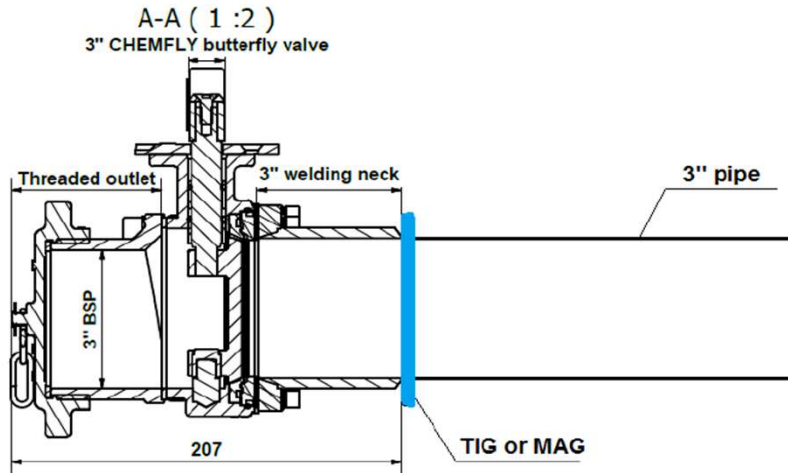

MAINTENANCE

ITEM	DESCRIPTION	PART N°
1, 2	3" BSP cap kit	12 85 59 91 00
4a	3" BSP short outlet	17 12 09 70 00
4b	3" BSP long outlet	17 12 09 71 00
3	Screw kit: 4 x M10 CHC screws, 4 washers	17 12 11 91 00
5	Outlet gasket PTFE	17 12 21 00 01
6	3" CHEMFLY butterfly valve	LY3110
8	Screw kit: 4 x M12 CHC screws, 4 washers, 4 nuts	17 12 11 92 00
7	Inlet gasket (synthetic fibers)	17 12 21 10 00
9a	Inlet welding	17 12 09 80 00
9b	Square inlet flange	17 12 09 81 00

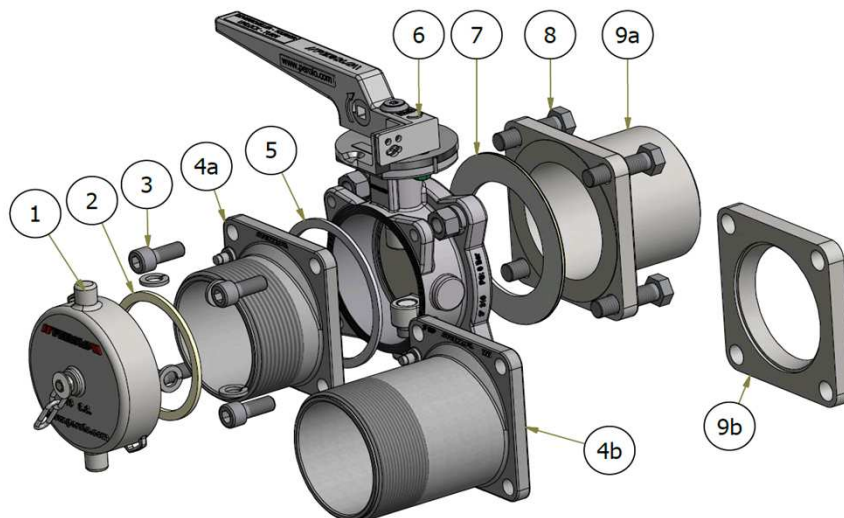

for maintenance of chemfly butterfly valve, please check maintenance sheet of chemfly butterfly valve

Due to our policy of continuous product improvement, specifications may change without notice - Installation sheet PWA 17 12 21 30 00 A

It is the customer's responsibility to check the compatibility between valves material and transported product.

PEROLO SAS, 69 Rue des Maçons, 33390 Blaye, FRANCE -Phone : + 33 (0)5 5742 67 00 - Email : sales@perolo.com