

MAINTENANCE



To assembly the Venting and Overturn Protection Device:

1. Insert the spherical poppet (3) and the ball (8) into the body (1).
2. Set the pin (6) on the body (1) in order to block the poppet (3).
3. Before setting the Overturn Protection Device on the tank flange mount the gasket (2) between both flanges
4. Mount the Overturning device on the tank flange and screw it with the studs kit (4).

The required tightening torque is 100 N.m +/- 5

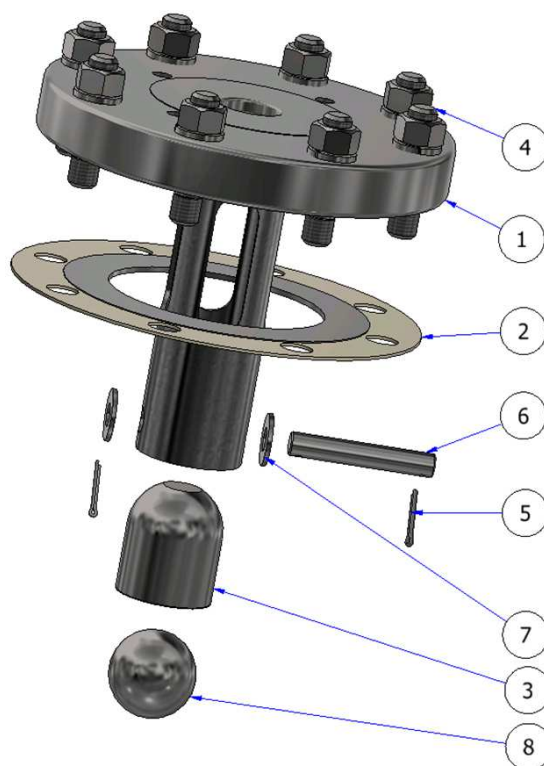

The venting and overturn protection device flange should be in contact with tank flange when tightened.

ITEM	DESCRIPTION	SPECIFICATION	PART N
8	Ball	Solid ball Ø60 304L	19 15 01 00 01
7	Washer	2 x washer Ø16	70 13 25 37 15
6	Locking pin	Locking pin Lg:100mm	19 15 01 10 01
5	Split pin	2 x split pin V4-28	70 13 20 37 09
4	Stud kit	8xNut M20-A4 ; 8xStuds bm20-70 A2; 8xWasher W20-A2	19 15 01 00 05
3	Spherical poppet	DN65	19 15 01 30 00
2	Seal	Ext Ø 282mm, Int Ø152,5mm, drilling 8x 22 x PCD240 thickness 2.5mm, CNAF/PTFE	19 15 01 12 01
1	Body	8 x Ø22 on a PCD240 ; 4 X M16 on a PCD160 ; Thickness 38mm, 304L/1.4307	19 15 01 10 00