

INSTALLATION

1. Disassemble the bolts with the screw
2. Weld the neckring on the tank.

TIG, MIG or MAG weld process are allowed. Check the material according to your tank and welding process.

3. Check that the sealing surface has no more than 1 mm flatness default.
4. Assemble the cover, hinge pin and all bolts. (Tightening Torque 60 N.m +/-5)

NB: the tank radius should be +/- 50mm compared to neckring radius in order to allow correct neckring welding on the tank.

MAINTENANCE

ITEM	QTY	DESIGNATION	PART N°
Coverlid & seal*			
1	1	8 points low profile standard sealing	CMS554D8SS
1	1	8 points low profile T.I.R. sealing	CMS554D8ST
1	1	6 points low profile standard sealing	CMS554D6SS
1	1	6 points low profile T.I.R. sealing	CMS554D6ST
1	1	8 points standard standard sealing	CMS554D8DS
1	1	6 points standard standard sealing	CMS554D6DS
2	1	Seal, PTFE/EPDM 14x14	11 13 75 00 19
2	1	Seal, Nitrile/PTFE 14x14	11 13 75 00 14
2	1	Seal, braided PTFE 15x14	11 13 75 00 15
2	1	Seal, Sweet White Rubber 14x14	11 13 75 00 18
Hinge pin kit			
3	1	Hinge pin 304 st st	12 13 68 91 00
5	2	Washers	
4	2	V4-28 pins	
58 mm swingbolt assembly (low profile)			
7	1	58 mm eye bolt 304L st st	12 93 86 92 00
6	1	Wing nut copper alloy	
9	1	M6x8 TBHC screw and washer	
8	1	Pivot pin	
83 mm swingbolt assembly (low profile & standard)			
7	1	83mm eye bolt 304L st st	12 93 86 91 00
6	1	Wing nut copper alloy	
9	1	M6x8 TBHC screw and washer	
8	1	Pivot pin	
Complete 8 points bolting kit low profile R>1000			
-	1	Hinge pin kit	11 18 53 92 00
-	4	58 mm Eye bolt assembly	
-	4	83 mm Eye bolt assembly	
Complete 6 points bolting kit standard			
-	1	Hinge pin kit	11 15 20 93 00
-	6	83 mm Eye bolt assembly	

Low profile : neckring ≤ 40 mm
Standard profile : neckring > 40 mm

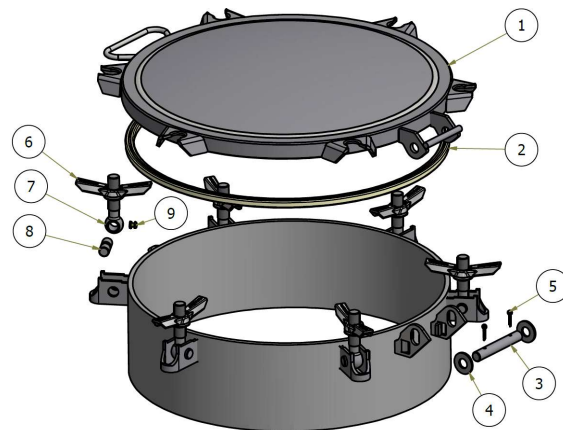
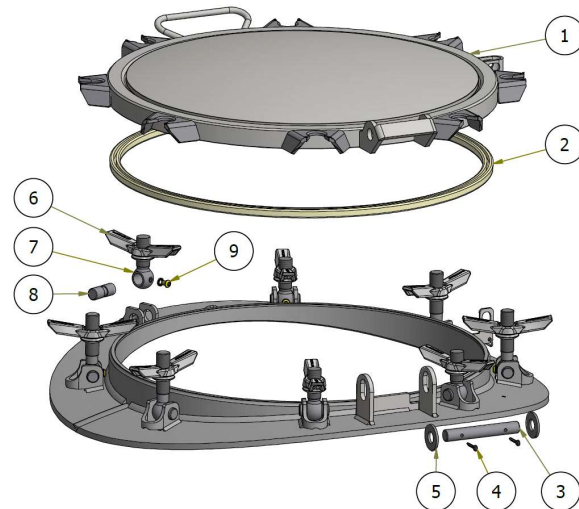

*for other seal material, please check the 'manlid gasket' sheet in accessories section