

MAINTENANCE

ITEM	QTY	DESIGNATION	PART N°
Spindle kit:			
8	1	Spindle, stainless steel	11 16 01 00 01
Spindle seal kit: 11 16 01 93 00			
1	1	Split pin, stainless steel	-
2	1	Washer, stainless steel	-
4	1	Spacer, stainless steel	-
6, 5	1	Packing gland, PTFE	12 85 30 30 00
7	1	Packing ring, PTFE	12 85 30 00 02
9	1	Spindle bush, PTFE	11 16 01 00 03
10	1	O'ring, FEP/silicone	70 10 15 00 12
11	1	End spindle bush, PTFE & 25% glass	17 16 23 10 01
Pushrod kit: 11 16 01 92 00			
12	1	M6-8 screw, stainless steel	-
13	1	M6 washer, stainless steel	-
14	1	Crank & pushrod, stainless steel	11 16 01 30 00
Bayonet cap & spring:			
18	1	Bayonet cap	11 16 01 00 04
17	1	Spring, stainless steel	12 85 38 00 02

ITEM	QTY	DESIGNATION	PART N°
Poppet kit: 1111149700mk2			
16	1	Poppet, stainless steel	11 16 01 20 00
15	1	O'ring, FEP/silicone	70 10 15 00 53
Poppet seal kit: 11 11 24 91 00			
15	1	O'ring, FEP/silicone	70 10 15 00 53
Handle kit: 12 85 24 93 00			
1	1	Split pin, stainless steel	-
2	1	Washer, stainless steel	-
3	1	Handle, stainless steel	11 11 69 0A 00

Nb: Perolo recommends the spindle seals should be changed simultaneously to maintain the valve spindle perfectly tight.

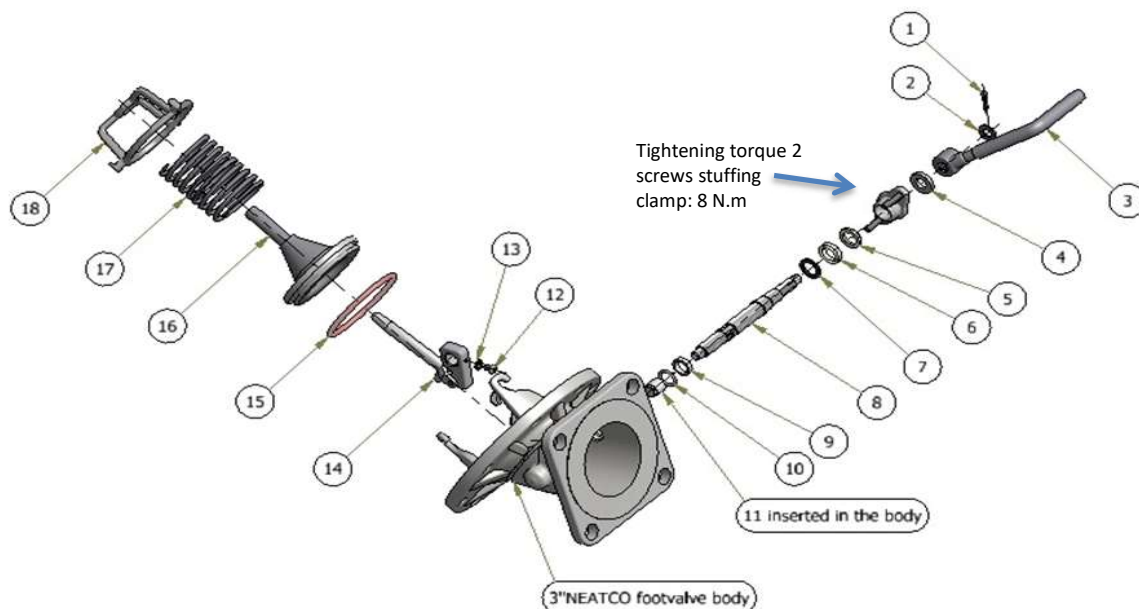

BOTTOM DISCHARGE